



# VERTUO PLUS



NESPRESSO



**SAFETY**



**OVERVIEW**



**FIRST STEPS**



**COFFEE PREPARATION**



**ADAPT YOUR COFFEE VOLUMES**



**CLEANING**



**DESCALING**



**EMPTYING THE SYSTEM**



**RESET TO FACTORY SETTINGS**



**TROUBLESHOOTING**



**SPECIFICATIONS**

## SAFETY

**CAUTION:** Before operating your coffee machine, please refer to the **safety instructions leaflet** to avoid possible harm and damage.

## DISPOSAL AND ENVIRONMENTAL PROTECTION

This appliance complies with the EU Directive 2012/19/EC. Packaging materials and appliance contain recyclable materials. Your appliance contains valuable materials that can be recovered or can be recycled. Separation of the remaining waste materials into different types facilitates the recycling of valuable raw materials. Leave the appliance at a collection point. You can obtain information on disposal from your local authorities.

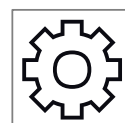
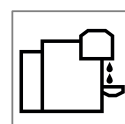
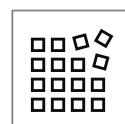
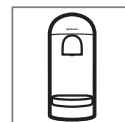

## OVERVIEW

**CAUTION:** First read the safety precautions to avoid risks of fatal electrical shock and fire. Please ensure ground continuity when plugging the machine into the power outlet.

### MACHINE OVERVIEW



Vertuo Plus D

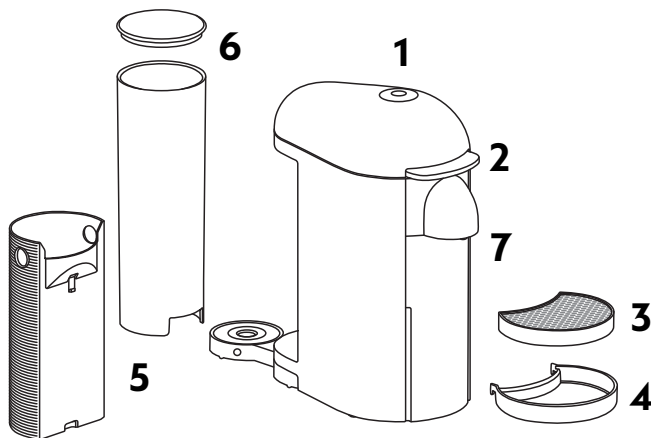

Vertuo Plus C

- 1 ON/OFF and Coffee Button
- 2 Open/Close Lever
- 3 Drip Grid
- 4 Adjustable Cup Support
- 5 Container for used Capsules
- 6 Water Tank and Lid
- 7 Coffee Outlet

### PACKAGING CONTENT



- 1 Coffee Machine
- 2 **Nespresso** Capsules Box
- 3 **Nespresso** Welcome Material
- 4 Safety Instructions
- 5 Quick Start Guide
- 6 Warranty

4 + 5 + 6

**i Unboxing:** When unpacking the machine, remove the plastic film. Some dust may be present due to recycled materials being used within the packaging. This is not dangerous, simply clean with a soft tissue.

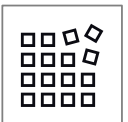

## OPEN / CLOSE

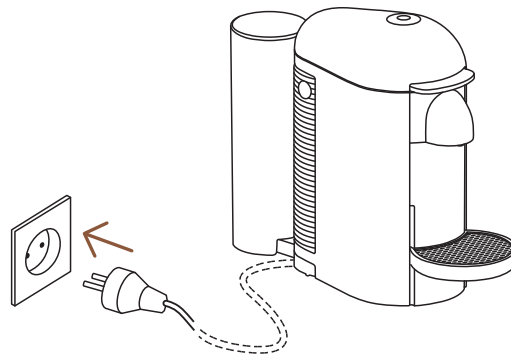

- 1** Plug the cord into a power outlet.

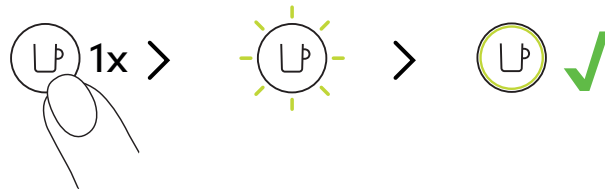

- 2** Turn the machine on by pressing the Coffee Button once.

### **3** OPEN

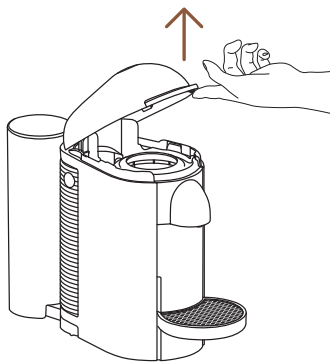

### CLOSE

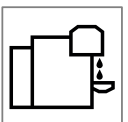
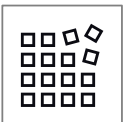
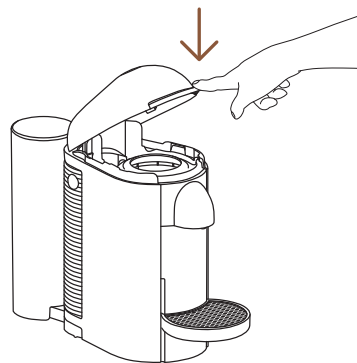

**CAUTION:** First read the safety precautions to avoid risks of fatal electrical shock and fire. Please ensure ground continuity when plugging the machine into the power outlet.

## THE VERTUO SYSTEM

### CAPSULE COMPATIBILITY



**S**

**Ristretto**

(25 ml / 0.84 fl oz)

**Espresso**

(40 ml / 1.35 fl oz)



**M**

**Double Espresso**

(80 ml / 2.7 fl oz)

**Gran Lungo**

(150 ml / 5.07 fl oz)

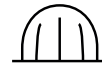

**L**

**Mug**

(230 ml / 7.77 fl oz)

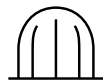

**XL**

**Alto, Cold Brew Style**

(355 ml / 12 fl oz)

**Carafe**

(535 ml / 18.8 fl oz)

### ACCESSORY COMPATIBILITY



Accessory  
compatibil-  
ity



**Ristretto**



**Espresso**



**Double  
Espresso**



**Gran  
Lungo**



**Mug (S)**



**Mug (M)**



**Reveal  
Glass**



Incompati-  
ble accesso-  
ries



**Mug (L)**



**Carafe**

Discover our full collection of accessories on [www.nespresso.com](http://www.nespresso.com)

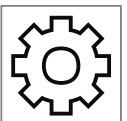
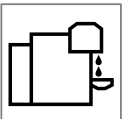
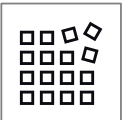

## ON/OFF

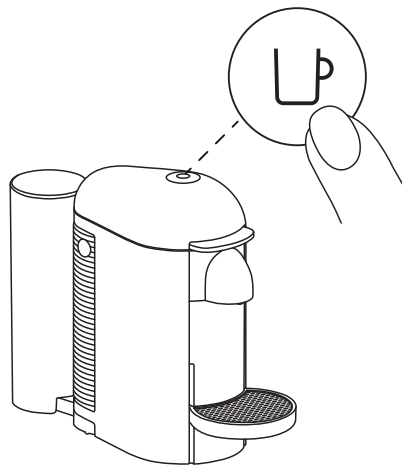

### ON

Once the machine is plugged in, turn it on by pressing the Coffee Button once.

- i** The light will blink for approximately 40 seconds while the machine is heating up. Once the light is steady, the machine is ready to be used.

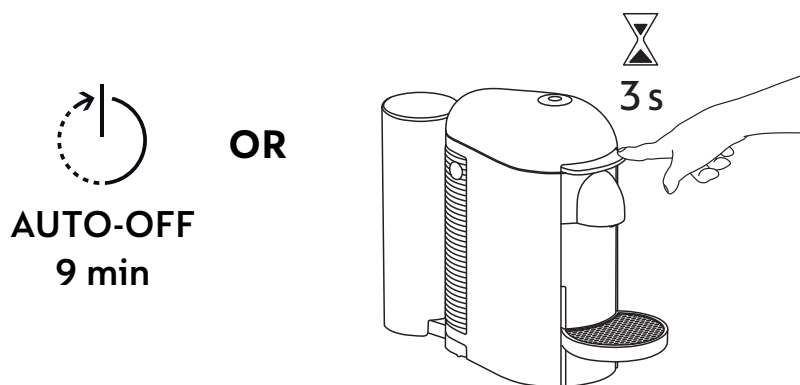

### OFF

To save energy, the machine will turn off automatically after 9 minutes of non-use.

- i** The machine can be turned “OFF” at any time by pressing and holding down the Open/Close Lever for 3 seconds.

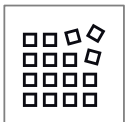

# FIRST STEPS

## FIRST RINSING

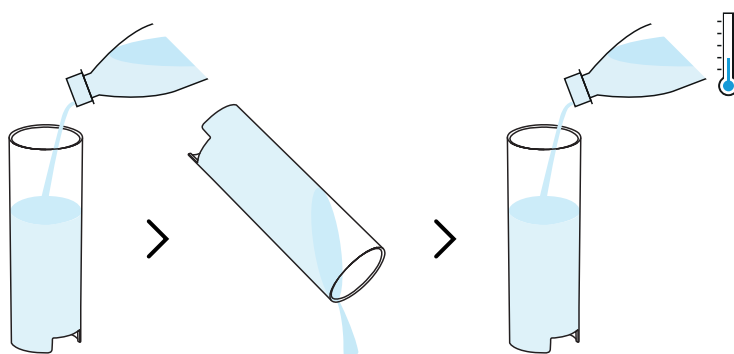

- 1** Rinse and clean the water tank and lid before filling it with fresh drinking water.

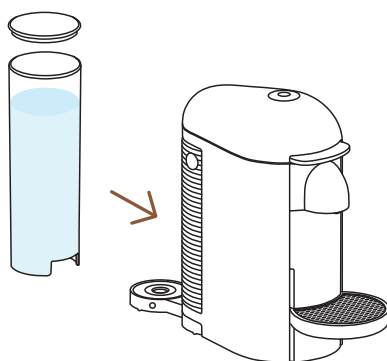

- 2** Put the lid on the water tank and put the water tank in place. Make sure it is properly attached.

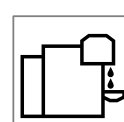
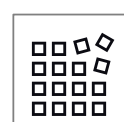



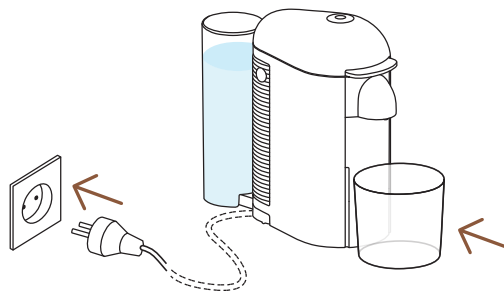

- 3** Plug the power cord in, remove the cup support and place an empty container (of at least 1 L / 34 fl oz) under the coffee outlet.

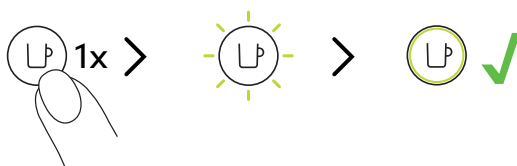

- 4** Turn on the machine by pressing the button once.

- i** It will take approximately 40 seconds for the machine to be ready to use.

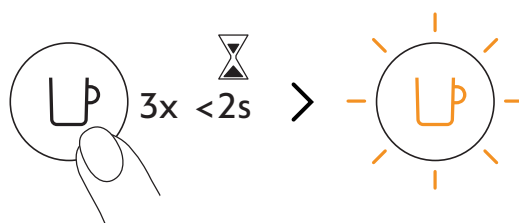

- 5** Press the button 3 times within 2 seconds to start rinsing. Let the rinsing procedure complete automatically. When the light becomes steady green, the cycle is complete.

- i** It should take less than 2 minutes before the rinsing process begins and water starts to flow. This procedure may take up to 5 minutes.

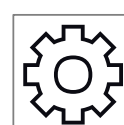
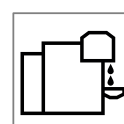
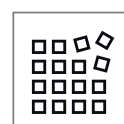

# COFFEE PREPARATION

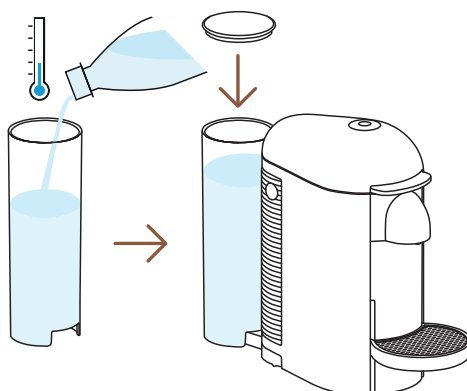

- 1** Fill the water tank with fresh drinking water and put it back in position.

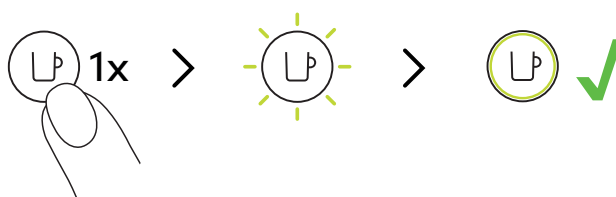

- 2** Turn on the machine by pressing the button once.

- i** Green light will blink while the machine is heating up. It will take approximately 40 seconds. When the green light becomes steady, the machine is ready to use.

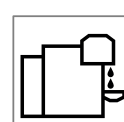
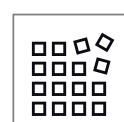

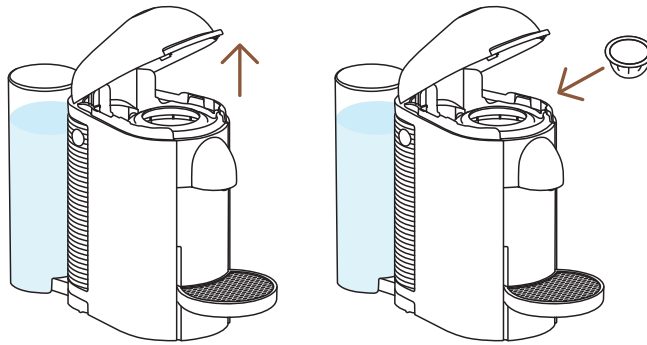

- 3** Open the machine and insert a Vertuo capsule with the dome shape facing down.

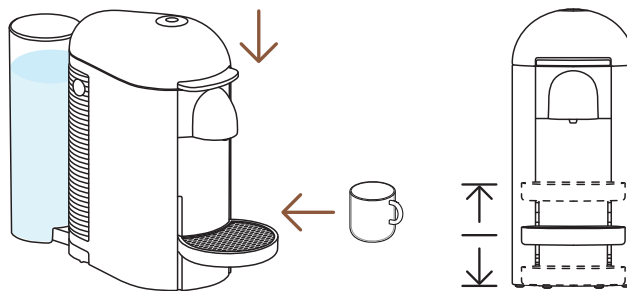

- 4** Close the machine head and place a cup. The cup support can be adjusted to accommodate your cup size.

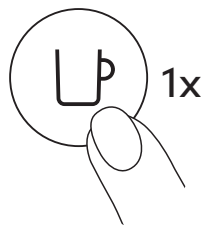

- 5** Start brewing by pressing the button once.

- i** Due to the barcode reading, coffee pre-wetting and infusion time, it will take a moment before the coffee begins to flow. The machine will automatically recognize the inserted capsule and select the coffee preparation parameters and cup length defined by **Nespresso** coffee experts to extract the coffee blends at it's best.

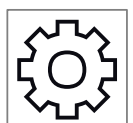
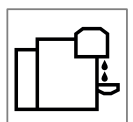
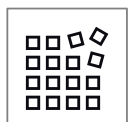

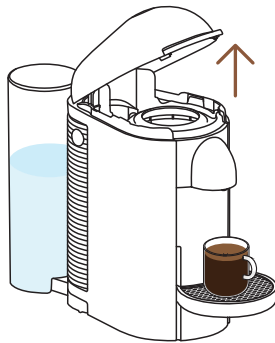

- 6** When the coffee stops brewing, open the machine, eject the capsule and enjoy your coffee.



- 7** Don't forget to recycle your **Nespresso** capsules.\*

\* THIS IS **NESPRESSO**. THIS IS RECYCLABLE. For more information about recycling your **Nespresso** capsules, visit [www.nespresso.com](http://www.nespresso.com)

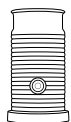

Discover how to upgrade your machine with our Aeroccino range on [www.nespresso.com](http://www.nespresso.com)

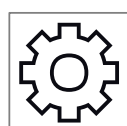
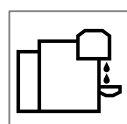
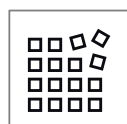
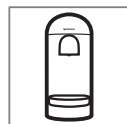

## ADAPT YOUR COFFEE VOLUMES

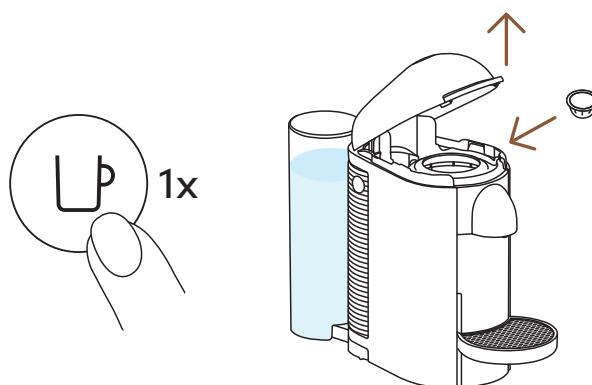

- 1 Turn on the machine by pressing the button once, open the machine head and insert the capsule you want to program.

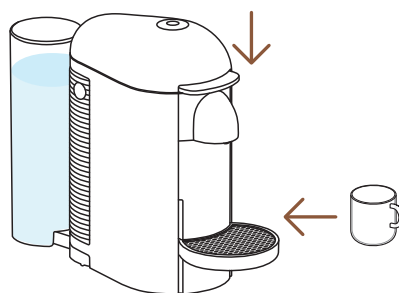

- 2 Close the machine head and place a cup on the cup support.

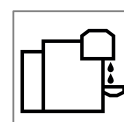
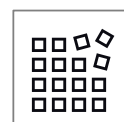

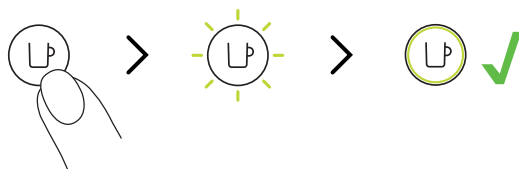

- 3** Press and hold the button, letting go a few seconds before the desired volume is reached. The new water volume is now programmed for the capsule type used during the setting.

- i** The programming is specific to each capsule type. Cup sizes may be programmed from 20 ml / 0.7 fl oz to 535 ml / 18 fl oz.

**NOTE:** Once a customer-specific volume is programmed by the user, every time that capsule type is inserted in the machine, the preparation will stop at the user-programmed cup size. If you wish to come back to the default parameters see the paragraph **“Reset to factory settings”**.

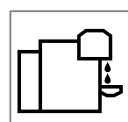
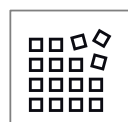

## CLEANING

Clean your machine on a monthly basis, when you start having coffee residue inside the machine head or after a long period of non-use.

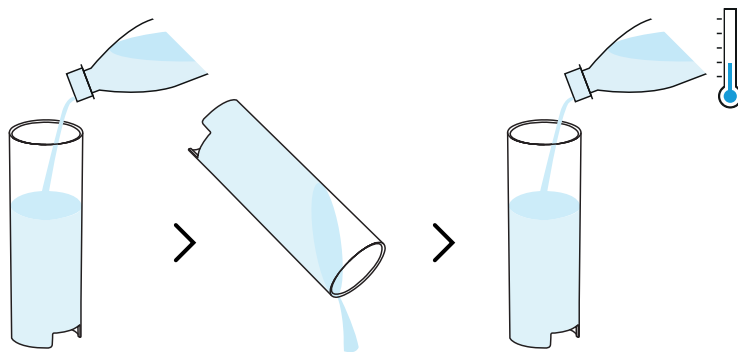

- 1** Rinse and clean the water tank and the lid before filling it with fresh drinking water.

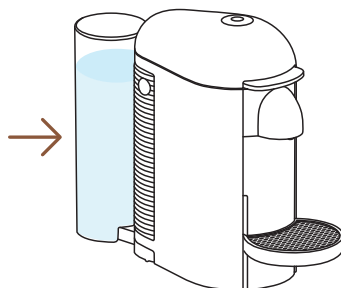

- 2** Put the water tank back in position on the machine.

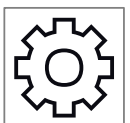
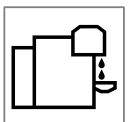
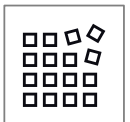

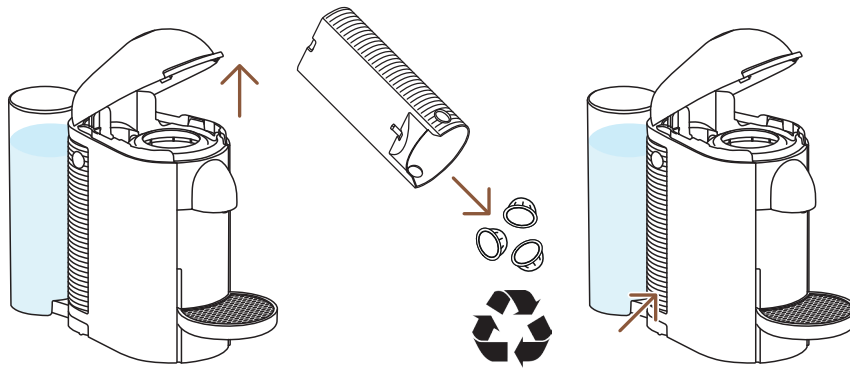

- 3** With your machine on, open the machine and eject your used capsule\*. Empty and rinse the capsule container and the drip tray and put them back in place.

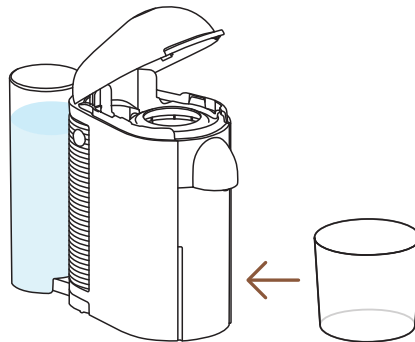

- 4** Remove the cup support and place an empty container (of at least 1 L / 34 fl oz) under the coffee outlet.

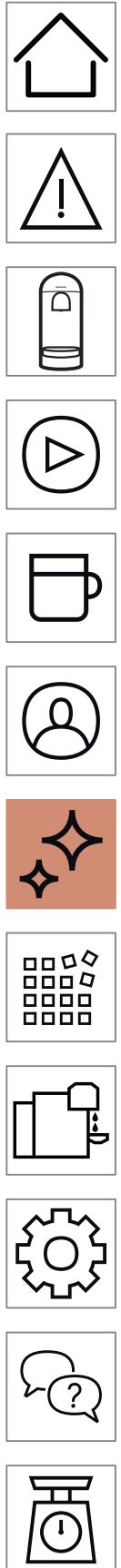

\* THIS IS **NESPRESSO**. THIS IS RECYCLABLE. For more information about recycling your **Nespresso** capsules, visit [www.nespresso.com](http://www.nespresso.com)



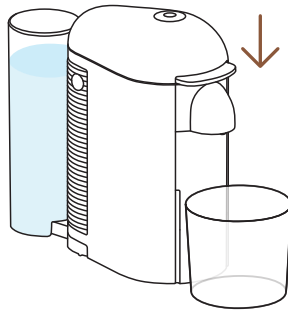

## 5 Close the machine head.

**NOTE:** Green light will blink while the machine is heating up. It will take approximately 40 seconds. When the green light becomes steady the machine is ready.

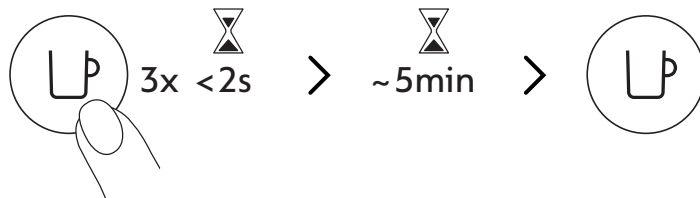

## 6 Press the button 3 times within 2 seconds to start rinsing. Let the cleaning procedure complete automatically.

- i** It should take less than 2 minutes before the cleaning process begins and water starts to flow. This operation may take up to 5 minutes and will stop automatically when the cycle is complete. The procedure can be stopped at any time by pressing the button.



## 7 When the green light becomes steady the machine is ready.

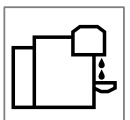
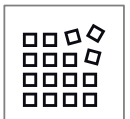

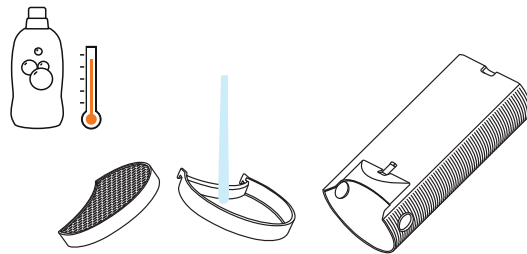

- 8** Wash the capsule container and the cup support with hot water and mild odourless detergent.

**CAUTION:** Do not use any strong or abrasive cleaning agent or solvent cleaner. Do not put the machine in a dishwasher. Never immerse the appliance or part of it in water.

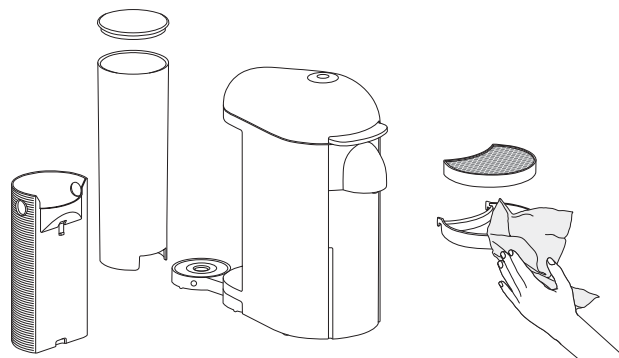

- 9** Dry the machine with a clean and fresh towel.

**CAUTION:** Clean the coffee outlet regularly with a clean damp cloth. Always use soft cloths to clean the machine.

**NOTE:** Water may accumulate inside the machine's head during cleaning. If this happens, please dry visible parts with a clean dry cloth.

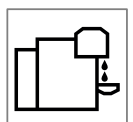
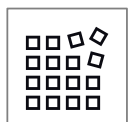

## DESCALING

Descaling your machine will ensure that it functions properly throughout its lifetime and will make your coffee experience as incomparable as it was the first day. Your machine will indicate when descaling is needed with a simultaneous red and green light.



**i** The descaling procedure takes ~20 minutes and **cannot be interrupted**.

**NOTE:** Please carefully read the descaling instructions before starting.

### You will need:

- A descaling kit available on [www.nespresso.com](http://www.nespresso.com)
- An empty container (of 1 L / 34 fl oz)

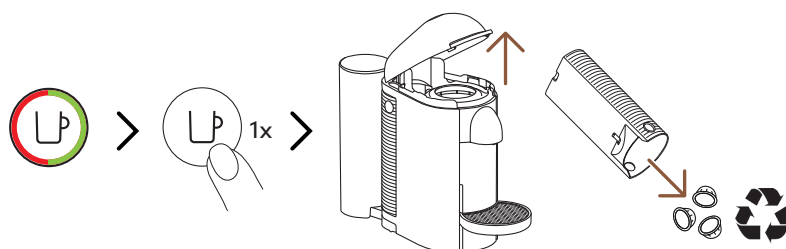

- 1** With the button half red, half green: Turn on the machine by pressing the button once. Open the machine head to eject any used capsule\*. Empty the capsule container and place it back in position on the machine.

\* THIS IS **NESPRESSO**. THIS IS RECYCLABLE. For more information about recycling your **Nespresso** capsules, visit [www.nespresso.com](http://www.nespresso.com)

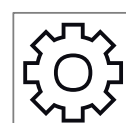
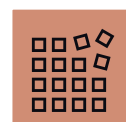

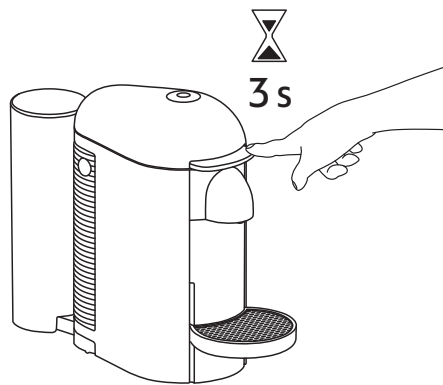

- 2** Close the machine and turn it off by pushing the lever down for 3 seconds.

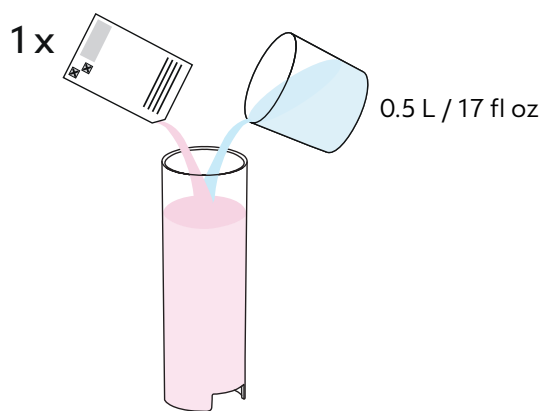

- 3** Fill the water tank with 0.5 L / 17 fl oz of water and add 1 unit of **Nespresso** descaling liquid.

**CAUTION:** Please note that the descaling solution can be harmful. Avoid contact with eyes, skin and surfaces.

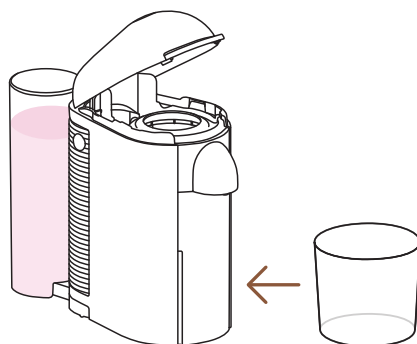

- 4** Remove the cup support and place an empty container (of at least 1 L / fl 34 oz) under the coffee outlet.

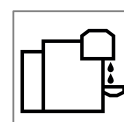
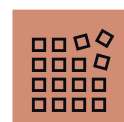

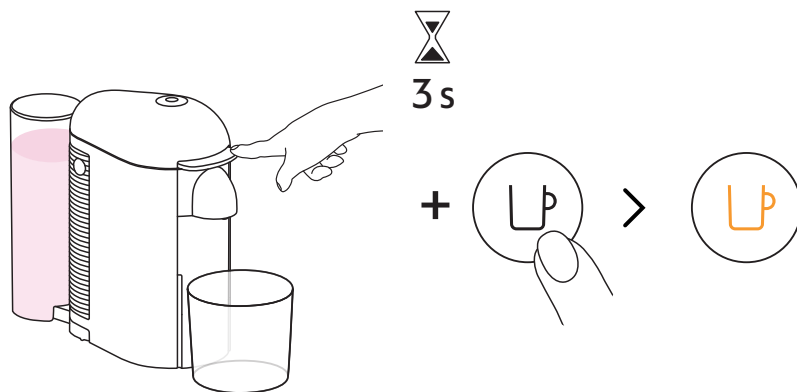

- 5** Push the lever down and press the button at the same time for 3 seconds. An orange steady light indicates your machine is in the menu mode.

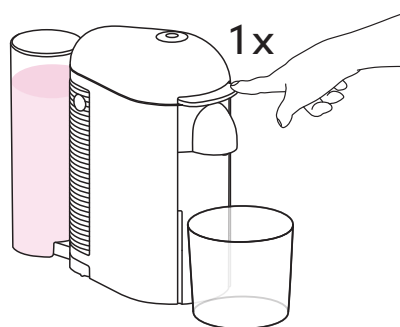

- 6** To enter the descaling mode, push the lever down once.

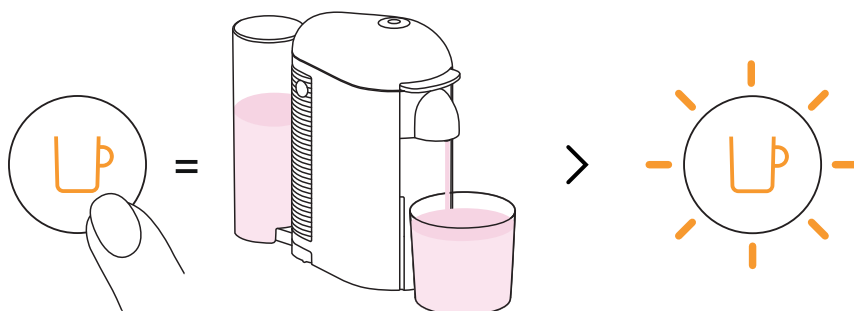

- 7** Press the button once.

- i** An orange light will blink during the entire descaling process. The machine will stop automatically when the first phase of descaling is completed.

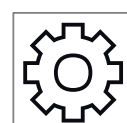
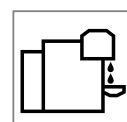

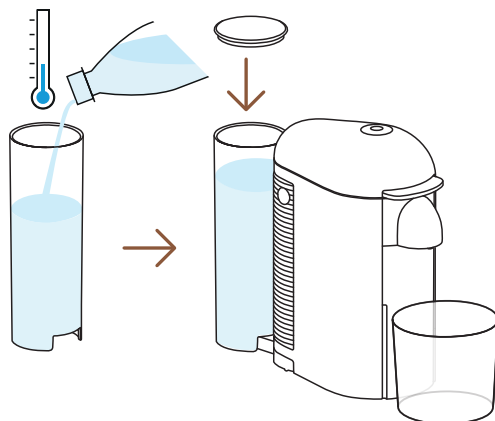

- 8** At the end of the descaling process, it is time to rinse the machine. Rinse the water tank and drip tray thoroughly. Fill the water tank with fresh drinking water and put it back in place. Empty the container and place it back under the coffee outlet.

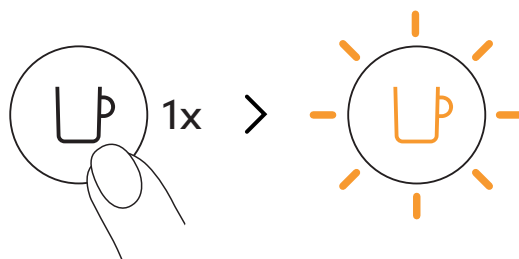

- 9** Press the button once to start rinsing. Let the rinsing procedure complete automatically. Orange light will blink during the process. It should take less than 2 seconds before the rinsing process begins and water starts to flow.
- i** This operation may take up to 5 minutes and will stop automatically when the cycle is complete. The procedure can be stopped at any time by pressing the button.



- 10** When the light becomes steady green the rinsing is done.

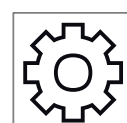
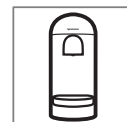

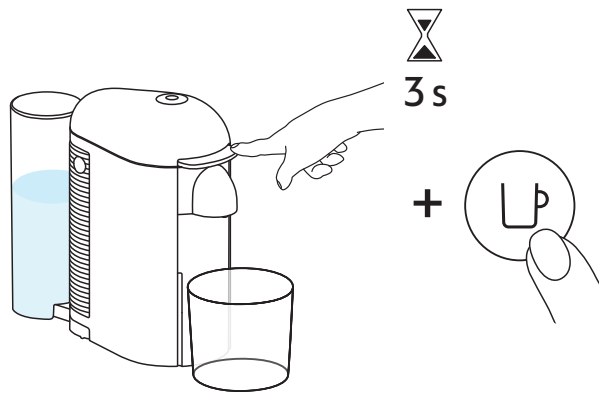

- 11** To exit the descaling mode, push the lever down and press the button at the same time for 3 seconds.

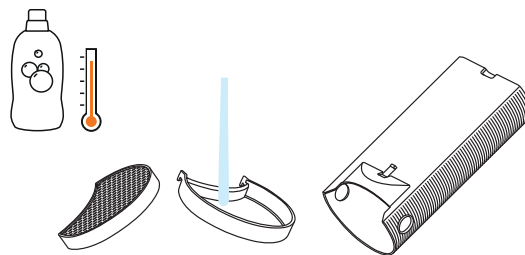

- 12** Wash the capsule container and the cup support with hot water and mild odourless detergent.

**CAUTION:** Do not use any strong or abrasive cleaning agent or solvent cleaner. Do not put the machine in a dishwasher. Never immerse the appliance or part of it in water.

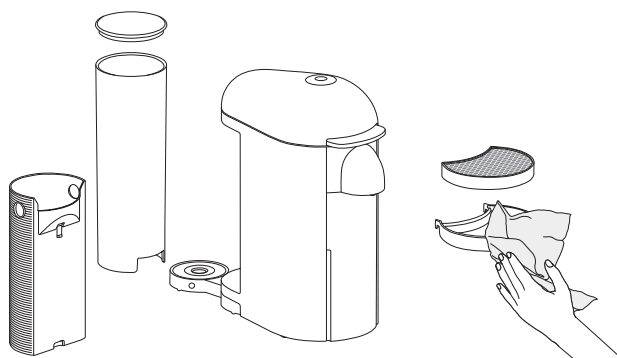

- 13** Dry the machine with a clean and fresh towel. Let the machine dry for 10 minutes before using it.

**NOTE:** Water may accumulate inside the machine's head during cleaning. If this happens, please dry visible parts with a clean dry cloth.

**NOTE:** the machine can only enter descaling mode after 30 or more coffees have been brewed.

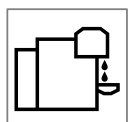
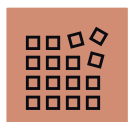

## EMPTYING THE SYSTEM

Emptying the system is a process that could be done before a period of non-use, for frost protection or prior to sending the machine for a repair.

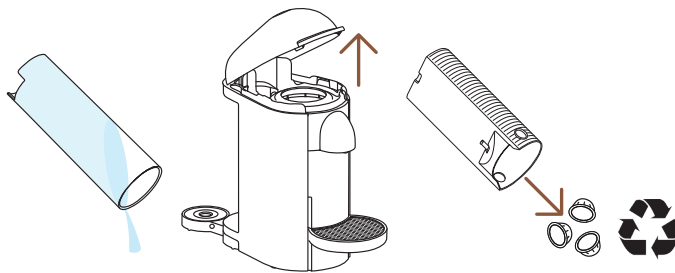

- 1 With the machine on, empty the water tank, open the machine head, and let the used capsule be ejected. Empty the capsule container. Don't forget to recycle your **Nespresso** capsules.\*

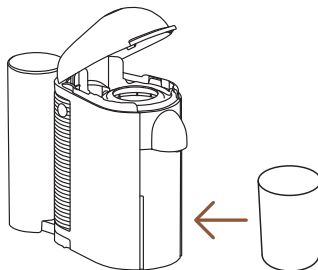

- 2 Place them back in position on the machine, remove the cup support and place an empty container (0.5 L / 17 fl oz) under the coffee outlet.

\* THIS IS **NESPRESSO**. THIS IS RECYCLABLE. For more information about recycling your **Nespresso** capsules, visit [www.nespresso.com](http://www.nespresso.com)

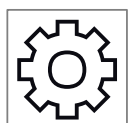
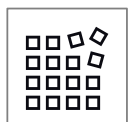



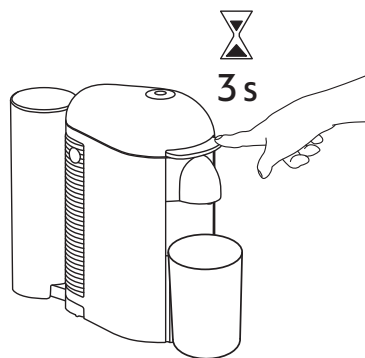

- 3** Close the machine and turn it off by pushing the lever down for 3 seconds.
- 

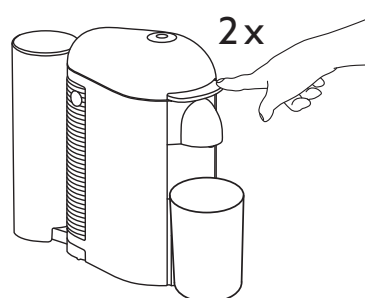

- 4** Push the lever down 2 times.
- 

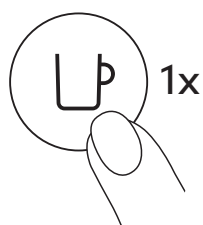

- 5** Press the button once.

- i** It will take approximatively 30 seconds for the machine to complete the emptying process. The machine turns off automatically when it is empty.

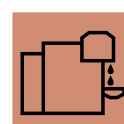
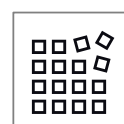

## RESET TO FACTORY SETTINGS

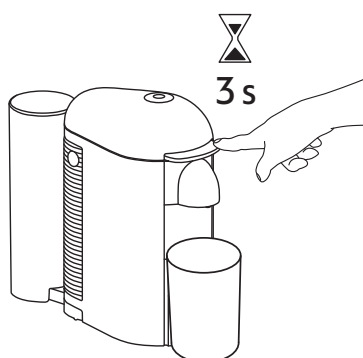

- 1** With the machine plugged in, push the lever down for 3 seconds.
- 

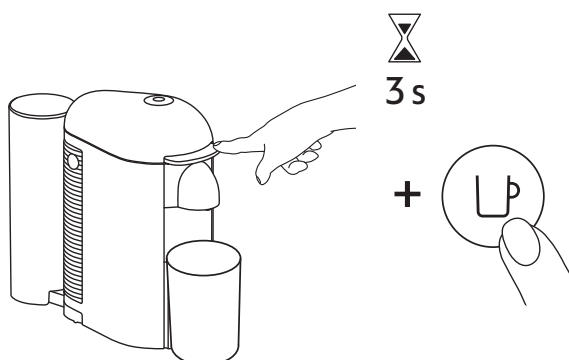

- 2** Push the lever down and press the button at the same time for 3 seconds.
- 

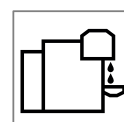
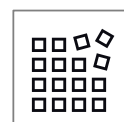

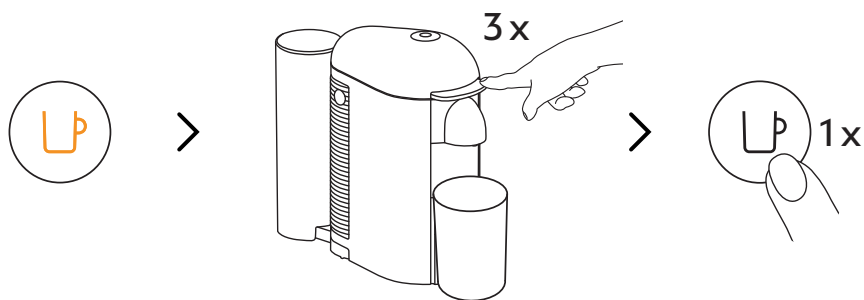

- 3** An orange light indicates your machine is in menu mode. Then to reset to factory settings, press down on the lever 3 times and then press on the button once.

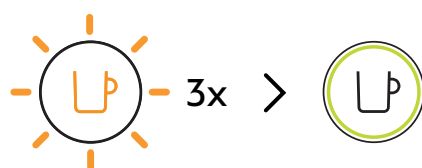

- 4** An orange light will blink 3 times in 3 seconds before becoming a steady green light. The machine is now reset to factory settings.

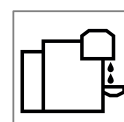
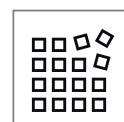

## TROUBLESHOOTING

- |                                        |                                                                                                                                                                                                                                                                                                                                                                                                             |
|----------------------------------------|-------------------------------------------------------------------------------------------------------------------------------------------------------------------------------------------------------------------------------------------------------------------------------------------------------------------------------------------------------------------------------------------------------------|
| <b>No light on the button.</b>         | <ul style="list-style-type: none"> <li>• The machine has turned OFF automatically; press the button or “UNLOCK” the machine.</li> <li>• Check the mains, plug, voltage, and fuse.</li> </ul>                                                                                                                                                                                                                |
| <b>No coffee, no water.</b>            | <ul style="list-style-type: none"> <li>• Check that the water tank is filled.</li> <li>• Check that a fresh capsule is inserted in the correct position, that the lever is properly locked and press the button to start.</li> <li>• Descale if necessary.</li> <li>• Open the machine head and eject any used capsule that is in the machine. Then perform a clean as per the cleaning section.</li> </ul> |
| <b>Coffee is not hot enough.</b>       | <ul style="list-style-type: none"> <li>• Preheat the cup with hot drinking water from the tap.</li> <li>• Descale if necessary.</li> </ul>                                                                                                                                                                                                                                                                  |
| <b>Leakage or unusual coffee flow.</b> | <ul style="list-style-type: none"> <li>• Check that the water tank is well positioned.</li> <li>• Descale if necessary.</li> </ul>                                                                                                                                                                                                                                                                          |
| <b>Machine turns to “OFF mode”.</b>    | <ul style="list-style-type: none"> <li>• To save energy the machine will turn off after 9 minutes of non-use.</li> <li>• The machine can be turned “OFF” manually at any time (when not in use) by pressing down on the lever for 3 seconds.</li> </ul>                                                                                                                                                     |
| <b>Coffee grounds in the cup.</b>      | <ul style="list-style-type: none"> <li>• Perform the cleaning procedure twice.</li> <li>• See paragraph on <b>“Cleaning”</b>.</li> </ul>                                                                                                                                                                                                                                                                    |
| <b>Coffee leakage</b>                  | <ul style="list-style-type: none"> <li>• Open the machine head and let the capsule be ejected. Then perform a cleaning as per cleaning section.</li> <li>• Empty and clean the cup support.</li> <li>• Descale if necessary.</li> <li>• If the problem persists, call <b>Nespresso</b>.</li> </ul>                                                                                                          |

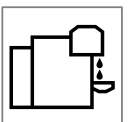
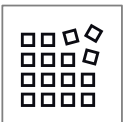

## SPECIFICATIONS

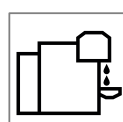
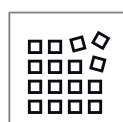
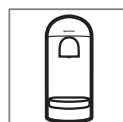

### Power

**~220–240 V, 50–60 Hz, 1260 W**

**US, CA:** 120 V, 60 Hz, 1300 W

**MX:** 127 V, 60 Hz, 1520 W

**BR, KR:** 220 V, 60 Hz, 1150 W

### Power saving mode

Auto-off after 9 min

### Heat-up time

40 seconds

### Movable cup support for large recipes

Adjustable

### Cable length from device dispatch

78 cm / 30 in

### Dimensions (W x D x H)

#### Water tank on the side

- Low End: 22 x 34.9 x 32.5 cm /  
8.7 x 13.7 x 12.8 in
- High End: 23.2 x 35.9 x 32.5 cm /  
9.1 x 14.1 x 12.8 in

#### Water tank on the back

- Low End: 14.2 x 41.2 x 32.5 cm /  
5.6 x 16.2 x 12.8 in
- High End: 14.2 x 42.3 x 32.5 cm /  
5.6 x 16.7 x 12.8 in

### Weight

From 4.3 to 4.6 kg (depending on the design) / From 9.5 to 10.1 lbs (depending on the design)

### Water tank capacity

Low End: 1.2 L / 40 fl oz  
High End: 1.8 L / 60 fl oz

### Capsule container capacity

14 espresso or 10 mug capsules

## MACHINE CODES

### Nespresso

GCB2, GDB2

### Breville

BNV320, BNV350,  
BNV420, BNV450

### Delonghi

ENV155

### Krups

XN900

### Magimix

M600

